

The HWH® SpaceMaker® Four-Cylinder Hydraulic Room Extension (with HWH® Synchronizing Cylinder)

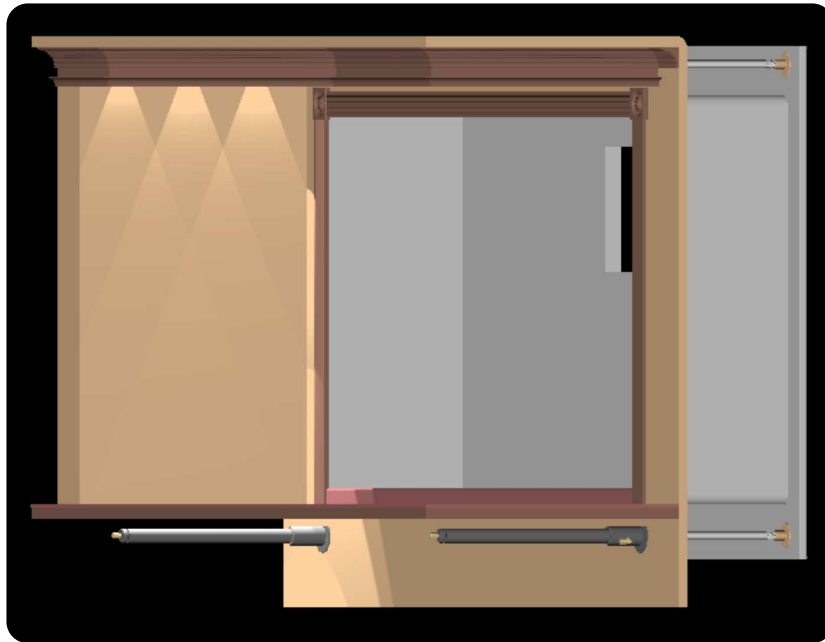

Features and Benefits

- ! Mechanism is light weight - minimizing the overall weight of the RV. (Entire mechanism weighs only 49.18 lbs., including pump weight.)
- ! Shares components with the HWH Leveling System - Weight Savings.
- ! Extends a 10'5" room out 20 inches.
- ! Utilizes HWH's patented synchronizing cylinder technology. (Synchronizes the four cylinders for smooth, even extension & retraction). The HWH Synchronizing Cylinder doesn't need to be located between the extension cylinders, thus leaving space between the extension cylinders open.
- ! Cylinders are hydraulically powered with the use of a momentary switch.
- ! Allows the underside of the room to be smooth.
- ! Equipped with an alternate room retracting mechanism. (For use, in the event of an electric or hydraulic failure.)
- ! Built with the same high quality construction & materials as HWH Leveling Systems. (Designed to withstand the environment and hold up over time.)



www.hwh.com/ml23562.wmv

(On I-80, Exit 267 South) | 2096 Moscow Road | Moscow, Iowa 52760 | Phone: (800)321-3494 or (563)724-3396 | Fax: (563)724-3 408
Web: www.HWH.com

STRONG, RELIABLE, HYDRAULIC POWER

SPECIFICATIONS

The HWH® SpaceMaker® : Four Cylinder Room Extension (w/Synch. Cyl.)

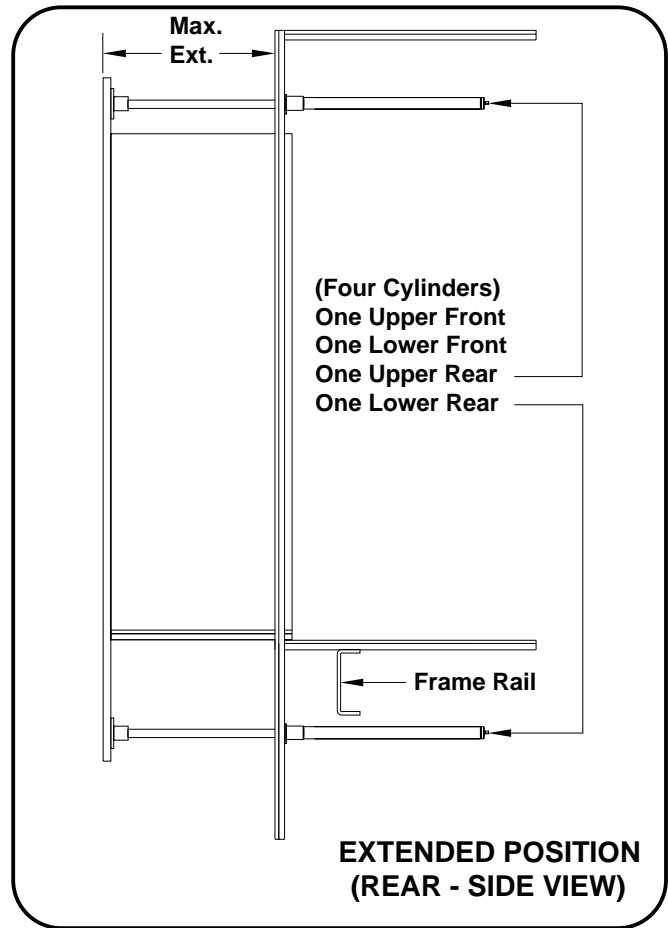
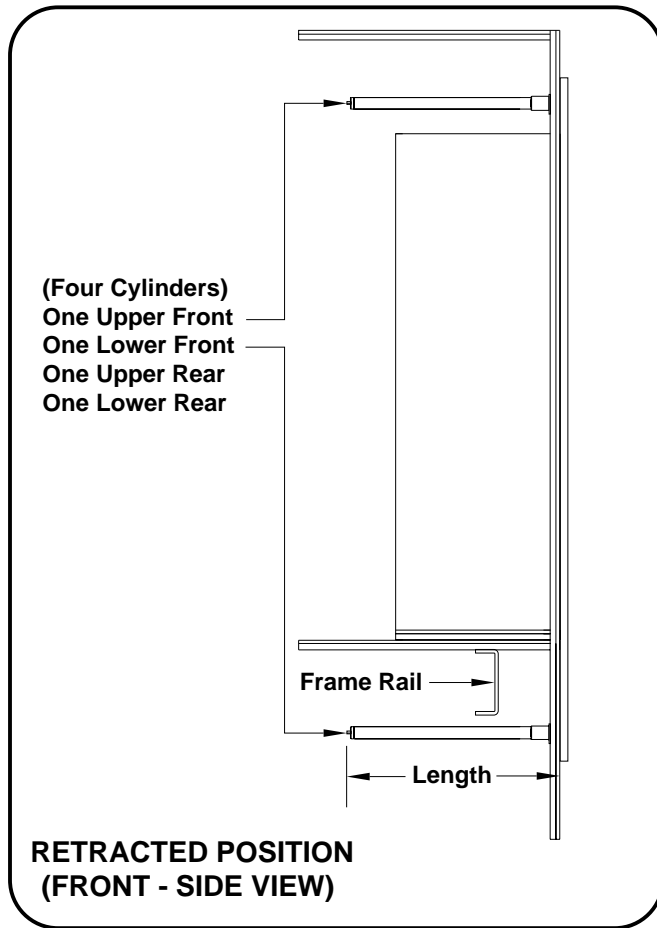

NOTE: SPECIFICATIONS VARY FOR DIFFERENT MODELS.

SPECIFICATIONS FOR SHOWN MODEL	
WEIGHTS (lbs.)	
Mechanism Assembly (Four Cylinders)	18.72
Synchronizing Cylinder	16.26
Pump *	14.20
Gross Weight *	49.18
DIMENSIONS (in.)	
Length (Retracted)	25.42
Max. Extension of Room	20.50
LOAD (lbs.)	
	2,000.00
FORCE of CYLINDER (lbs.)	
Max. Extending	2,000.00
Max. Retracting	2,000.00
PRIMARY APPLICATION	
Any Suitable Room	Interior / Below Floor

* If coach is equipped with an HWH Leveling System, pump is included.